



Finishes Bare Metal, Zinc Plated, Hot Dipped Galvanized

Materials Carbon Steel
See #82SS for Stainless Steel Specifications

Approvals Complies with MSS SP-58 and SP-69 (Type 8).
 cUL Approved (2" through 8" Bare, Zinc, & HDG)

Recommended For the support and stabilizing of vertical pipe runs.

*Maximum temperatures: Bare Metal 650°F,
 Galvanized & Epoxy 450°F*

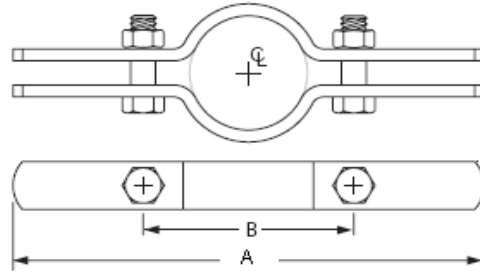

Installation Note:

The A and B dimensions shown are approximate. When using a riser clamp in any application other than what it is designed for (i.e., supporting a riser pipe between floors of a building) confirm against the product in hand the hole centers and overall length if they are critical to your installation.

IRON PIPE SIZE	SPECIFICATION DATA			REC. MAX. LOAD (LBS)	APP'X WT. PER 100 (LBS)	PC'S PER PKG.
	See Installation Note Above		BOLT DIAMETER			
	A	B				
1/2	8 5/8	2 1/8	3/8	220	88	25
3/4	8 13/16	2 5/16	3/8	220	92	25
1	9 1/16	2 5/8	3/8	220	94	25
1 1/4	9 7/16	2 15/16	3/8	250	100	25
1 1/2	10	3 7/16	3/8	250	104	25
2	10 9/16	4	3/8	300	114	25
2 1/2	11 1/8	4 9/16	3/8	400	160	25
3	11 13/16	5 1/4	3/8	500	170	25
3 1/2	13	6	1/2	600	206	25
4	13 5/8	6 5/8	1/2	750	220	20
5	14 1/8	7 5/8	1/2	1500	340	10
6	15 3/8	8 7/8	1/2	1600	372	10
8	18 5/8	12	5/8	2500	722	5
10	21	14 1/2	5/8	2500	1094	4
12	22 3/4	17	5/8	2700	1610	4
14	24	17 7/8	5/8	2700	1700	BULK
15	24 1/4	19 1/2	3/4	2800	2300	BULK
16	26	21	3/4	2900	2916	BULK
18	28	23 1/8	3/4	2900	3191	BULK
20	30	25	3/4	2900	3550	BULK
24	36	29 1/4	7/8	2900	4200	BULK
30	42	35 1/4	7/8	2900	6000	BULK
36	48	42	1	2900	9000	BULK

Recommended max torque #82 & #85 Riser Clamp	
Bolt Size	Torque Value (ft.-lbs)
1/4	6
5/16	11
3/8	21
7/16	32
1/2	46
5/8	100
3/4	150
7/8	190
1	280

QWI 4.3.1 Issue Date Nov/21 Rev.26

Note: when referencing a printed copy of this specification page, please insure it is the latest version as found on our website at www.taylorwalraven.ca

For more information, please contact Customer Service at 1-800-263-8652